

WELCOME

M.C.S srl and M-Tech Engineering are
pleased to welcome you.

Our consulting- designing services and
machine production for the vinyl
industries for you!

CUTTING LATHE



SILVERING MACHINE



Pre Nickel bath



GALVANIC MACHINE



Allegro II Introduction



Allegro II Features

Pressing machine

- ▣ Servo oil valve can control the rising and falling speed and pressure
- ▣ 100-ton hydraulic machine, and upgrade to powerful Servo motor which drives hydraulic pump.
- ▣ It runs fully only when pressing, save energy and quiet!



Allegro II Features

Cleanroom-like machine housing with HEPA filter

- ▣ Whole machine covered by housing with HEPA filter (air flow blower)
- ▣ Keeping machine inside clean and less effect from outside
- ▣ Reduce dust dropping on mirror and stamper during stamper exchange



Allegro II Features

Mold

- ▣ The mold is extremely precise. After the upper and lower molds are placed, they are centered within 0.02mm. The molds are easy to assemble and disassemble.
- ▣ Pnuematic cylinder lock for stamper holder, one-bottom to lock or release the holder

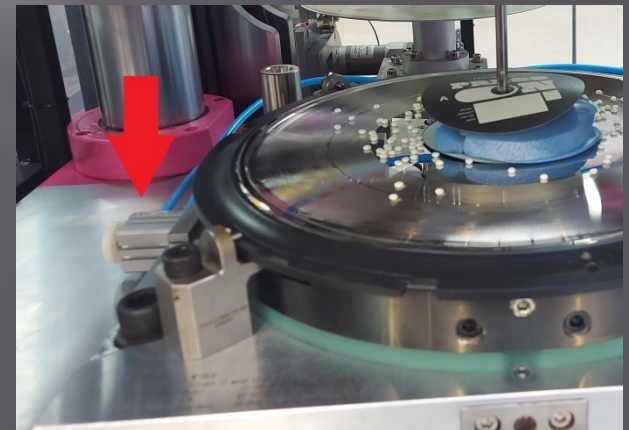
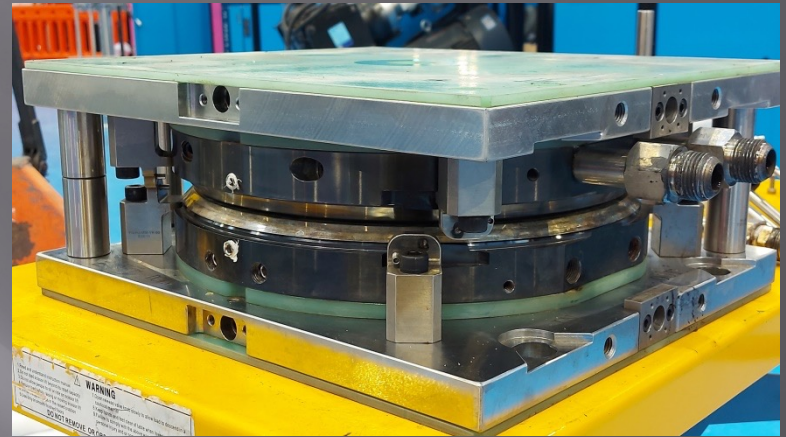

Allegro II Features

DLC (Diamond-like Carbon) coating

- ❑ Mirror is higher hardness, fine polishing, and with special DLC coating which is extremely smooth and hard
- ❑ Advantages: reduces friction between mirror and stamper so less Nickel peeling off from stamper. Increase the yield of production
- ❑ Vinyl disc is no material texture of mirror, reduce the background noise

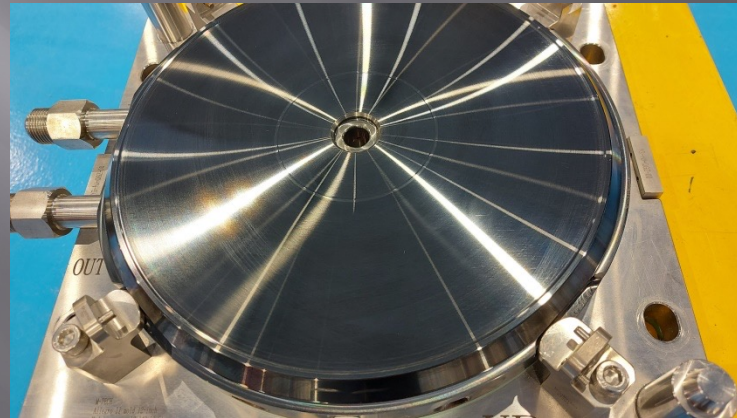

Allegro II Features

High Speed Take out robot arm

- ▣ The robot arm is driven by two sets of Mitsubishi servo motors, which can freely control the amplitude and speed of up, down, left and right movement
- ▣ High accuracy and repeatability of servo motor and easy adjustment



Allegro II Features

Control system

Full touch screen control
Full image display, easy to operate
All parameters can be set to match different processing

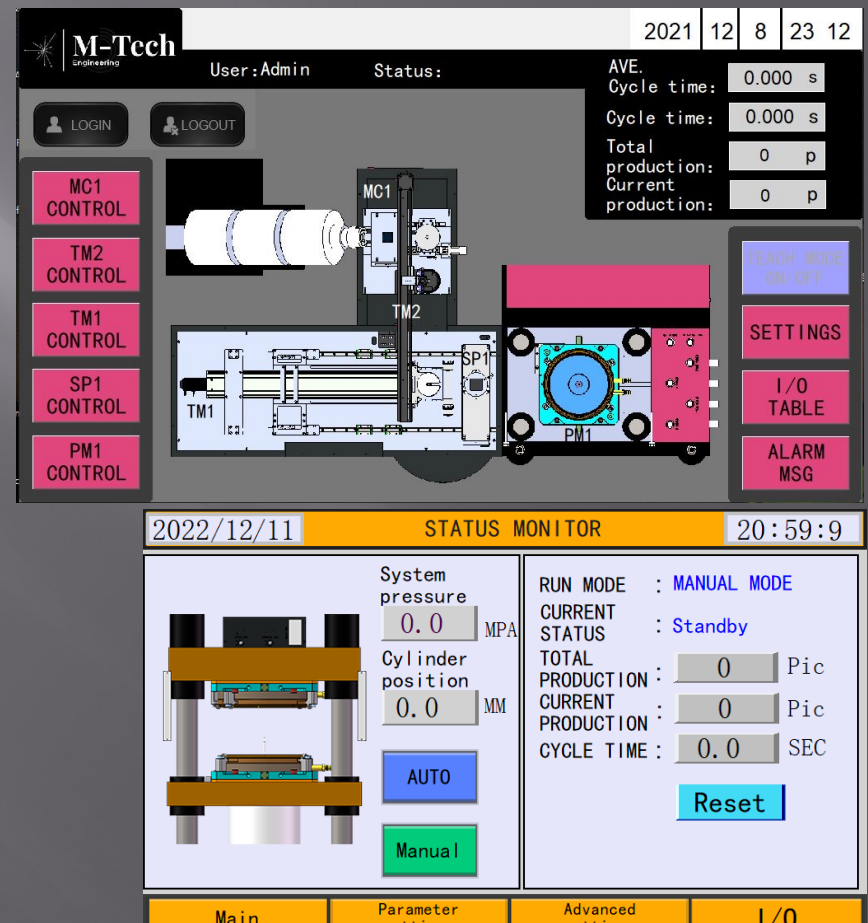
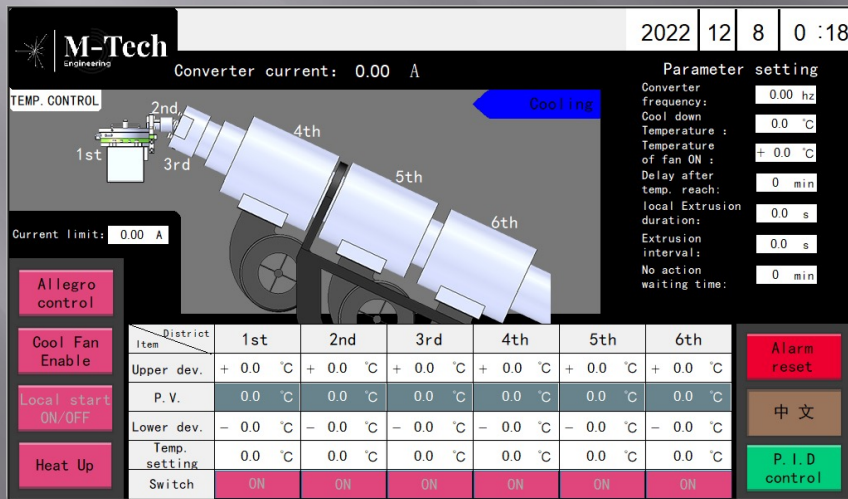

ADAGIO line

Manual Pressing machine



Manual Extruder with puck cake device

NEW MACHINES AND IDEAS FROM M-TECH AND MCS

ROOM TEMPERATURE NICKEL SPUTTERING DIRECT ON LACQUER DISC NEW GENERATION MASTERING

No more Silvering and Pre-Nickel
galvanic process

Easy, No chemical pollution and
Prefect replication of lacquer cutting

Sputtering Principle

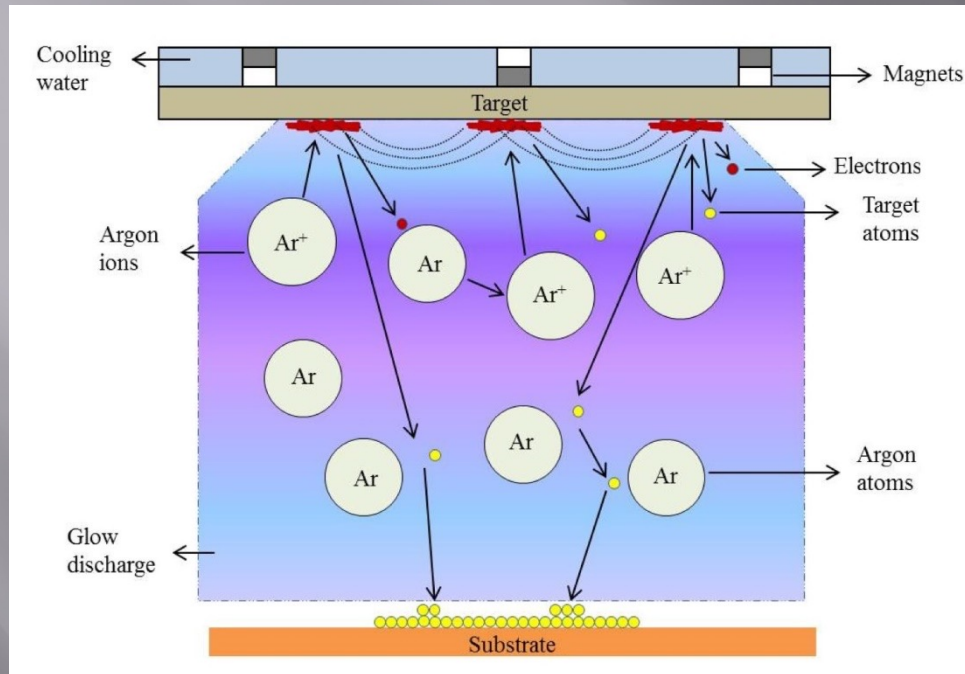

- ▣ Here Target is Nickel plate
- ▣ Substrate is lacquer disc
- ▣ Inside high vacuum chamber, Target is charged approx 500V and under strong magnetic field
- ▣ Argon atoms were ionized and hit to Nickel plate
- ▣ Nickel atoms drop to the lacquer disc surface and form thin layer
- ▣ Thickness can be controlled

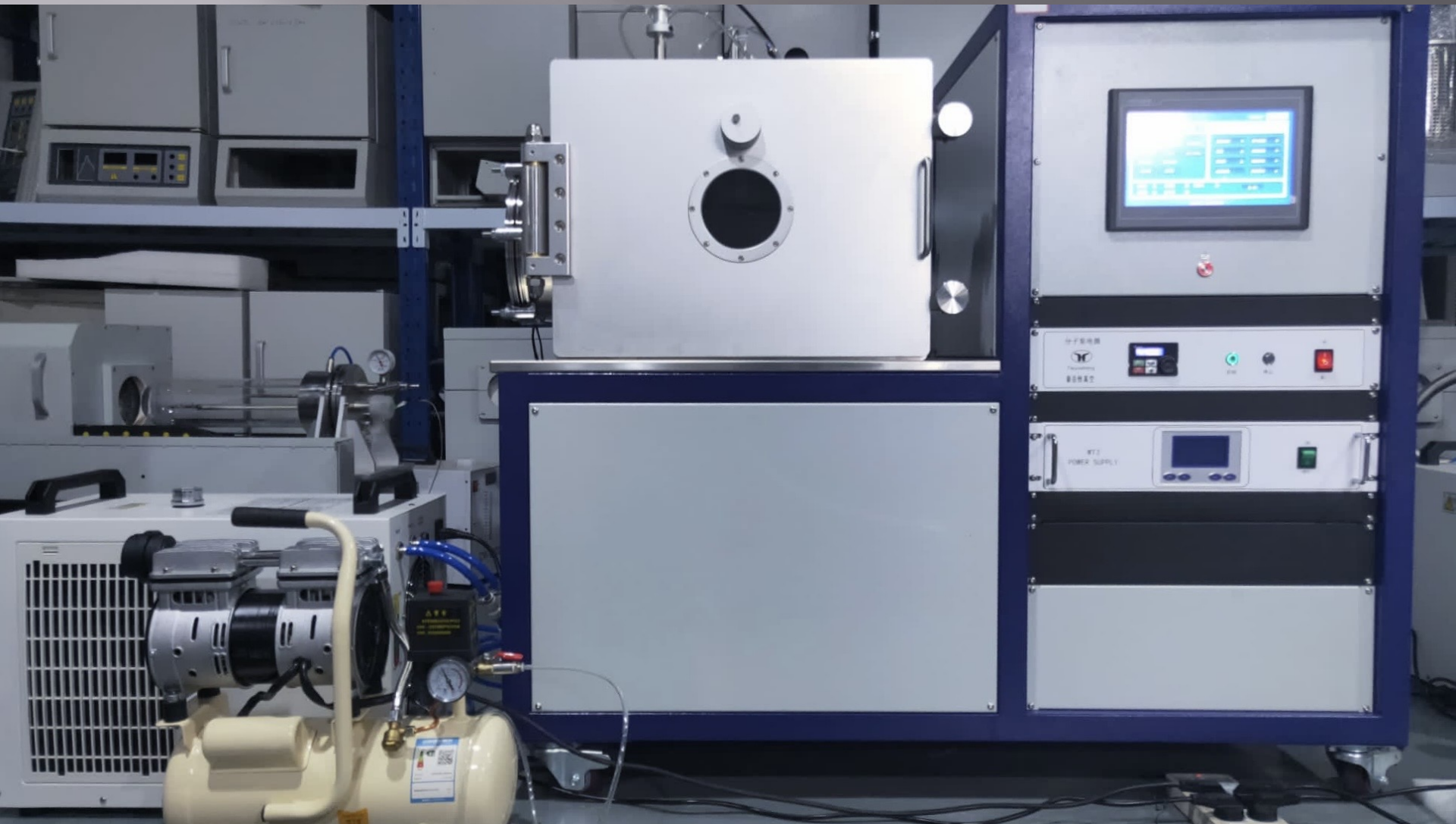

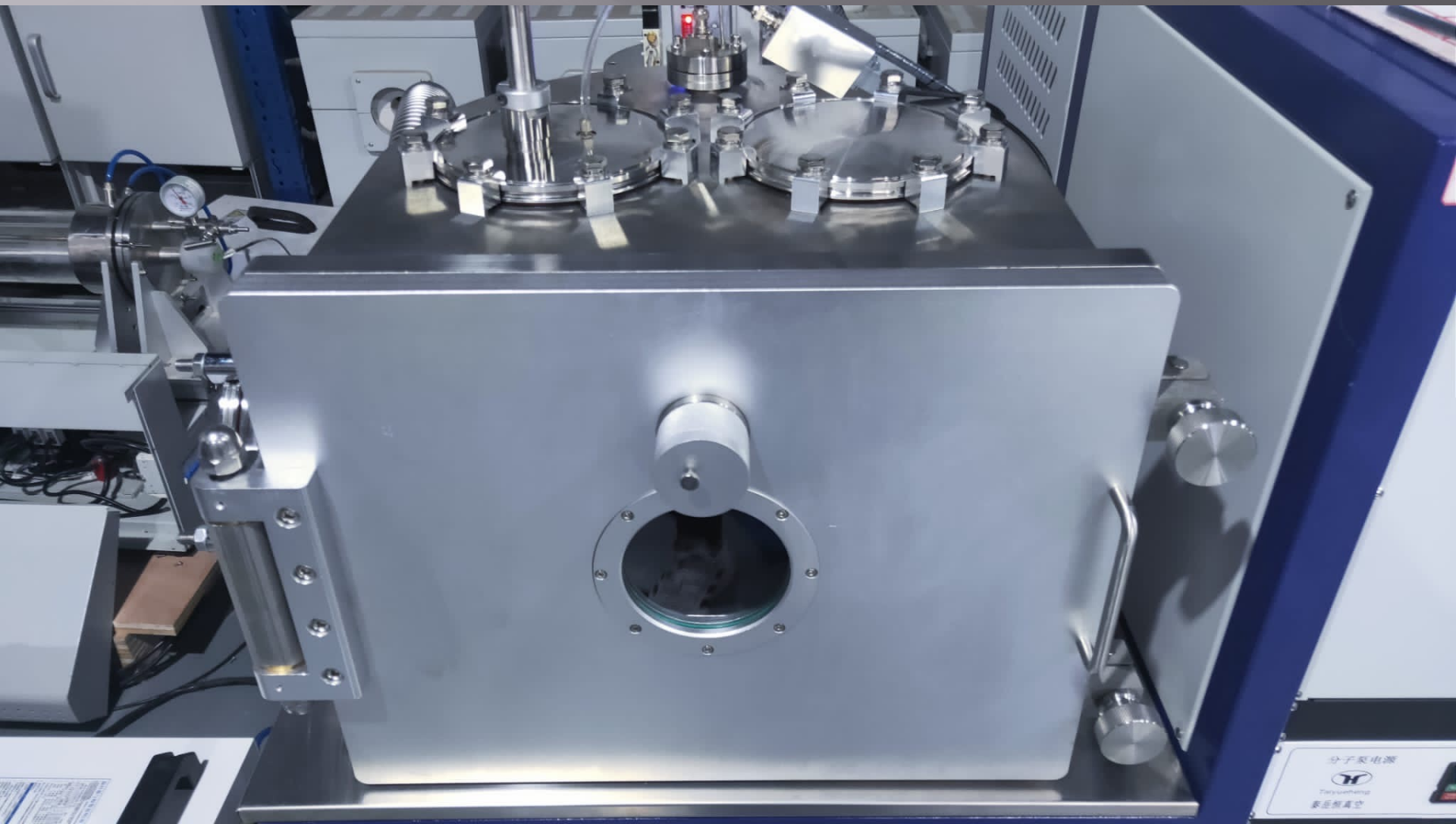





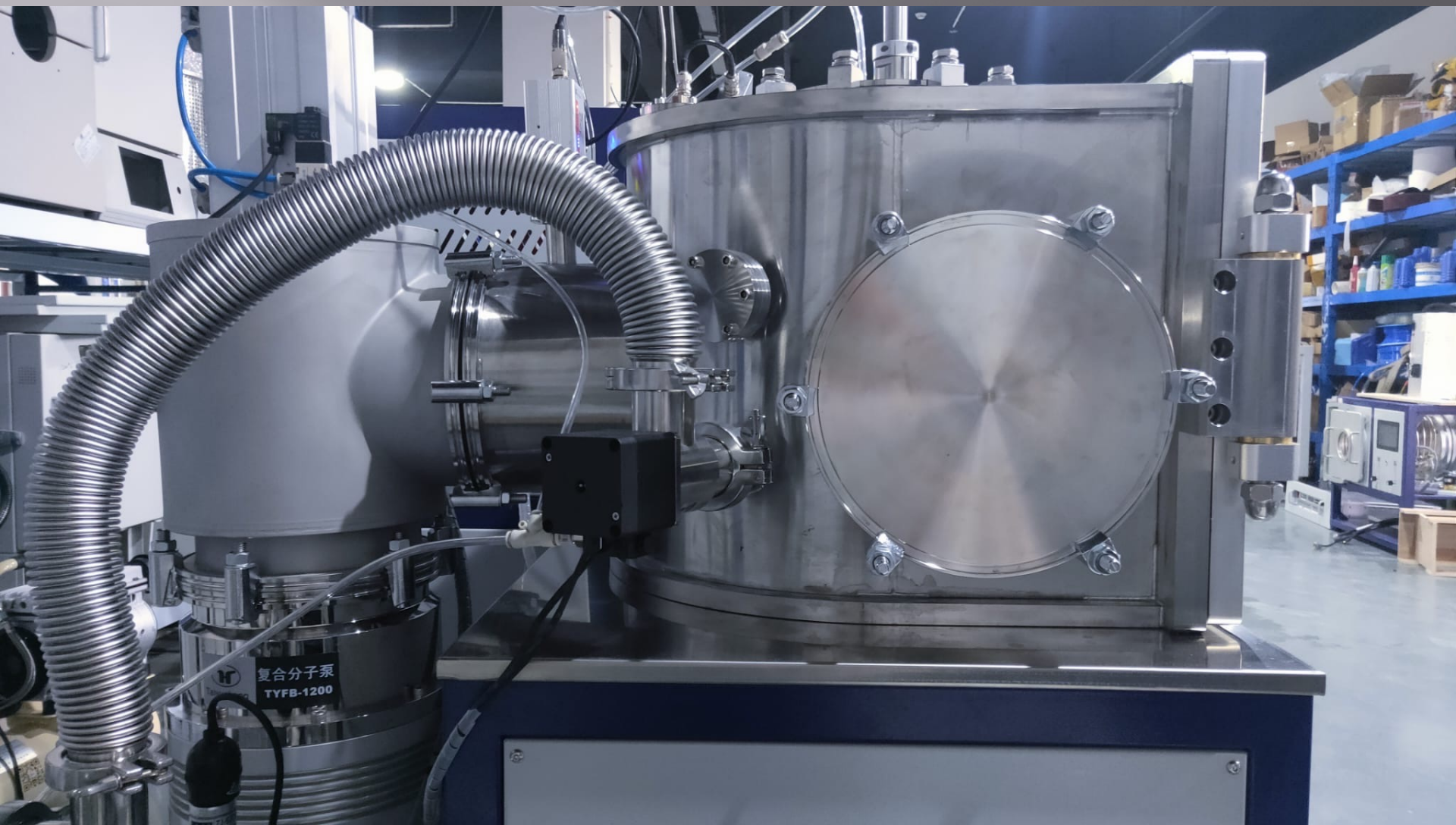





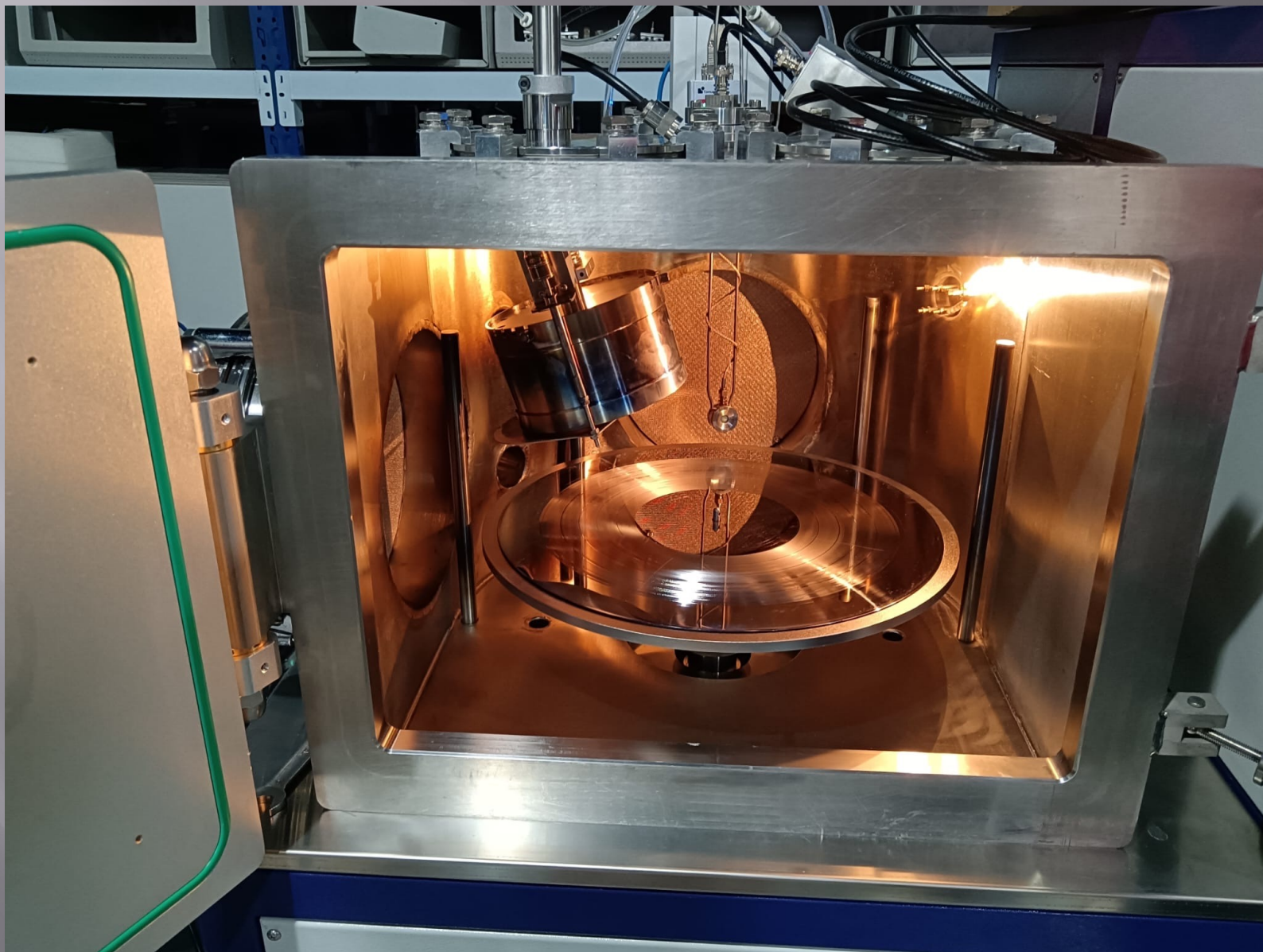



VINYL ZUMM 803

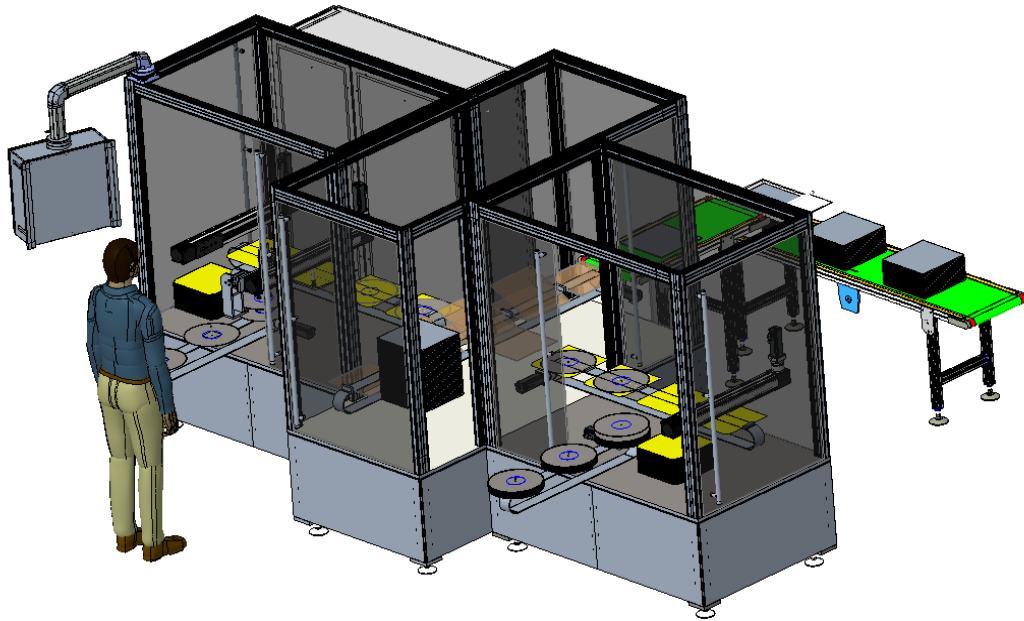

automatic machine for
the introduction of vinyl records in the cover

ZUMM 801/2

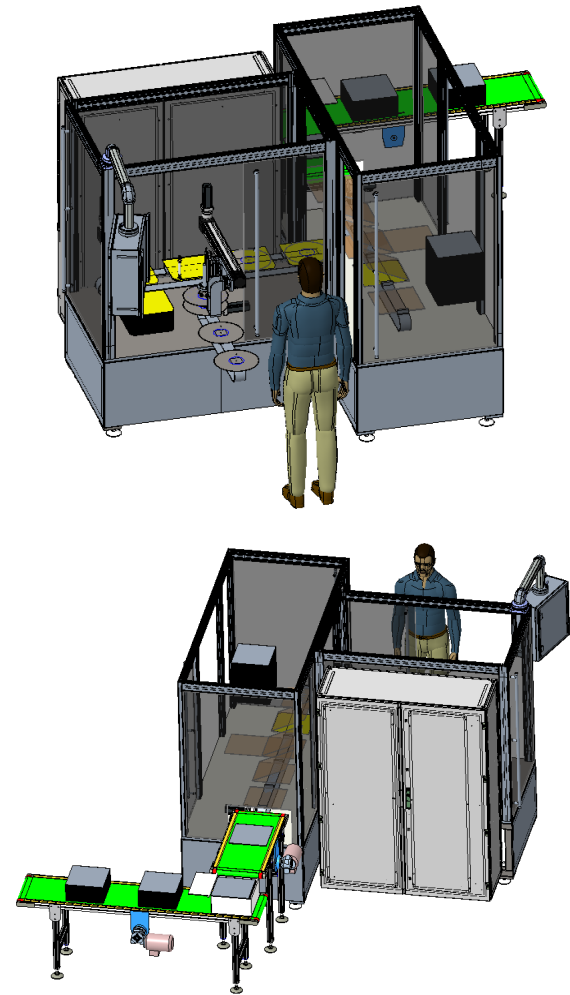
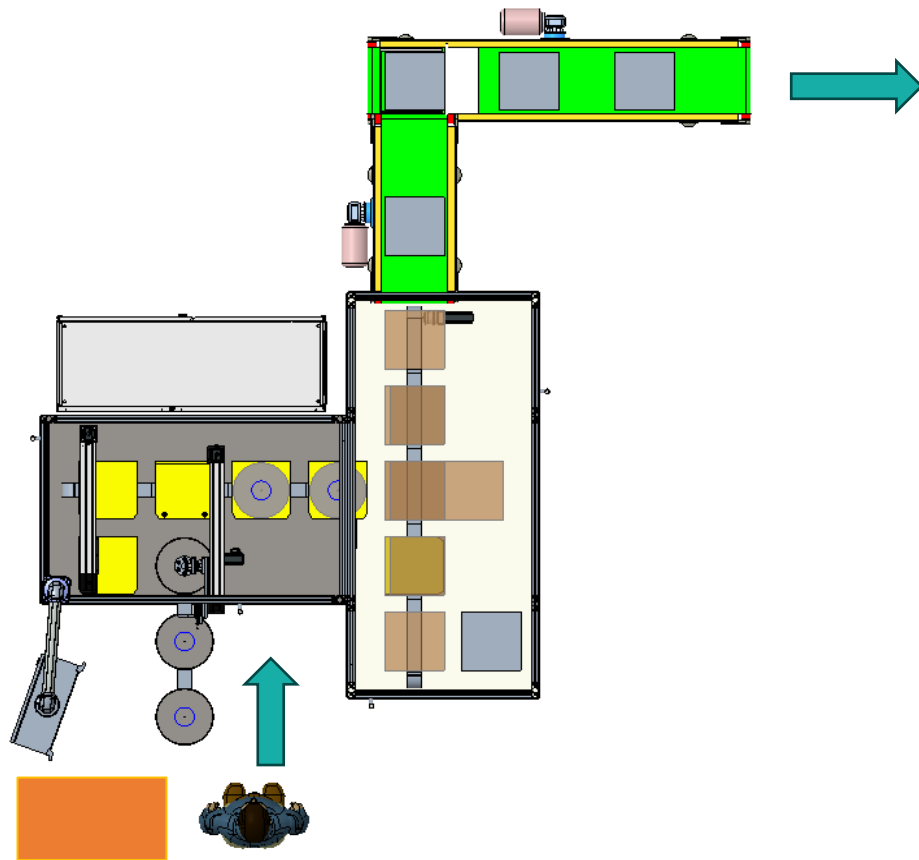

ZUMM 801/2

- LAYOUT

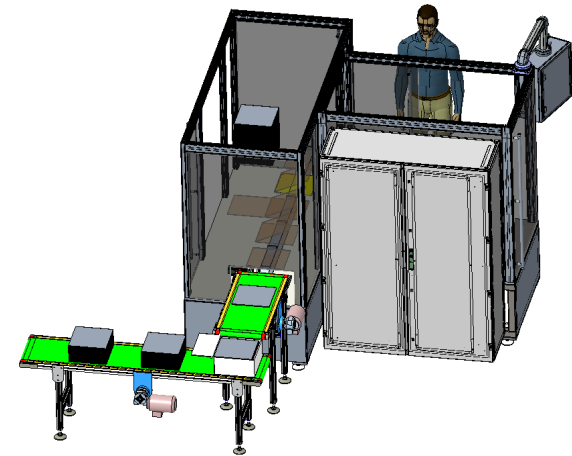
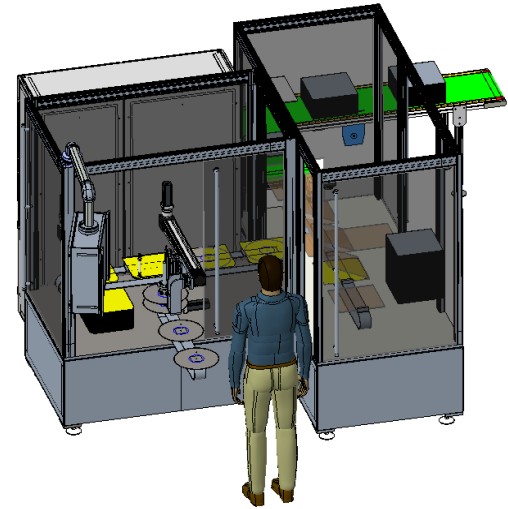
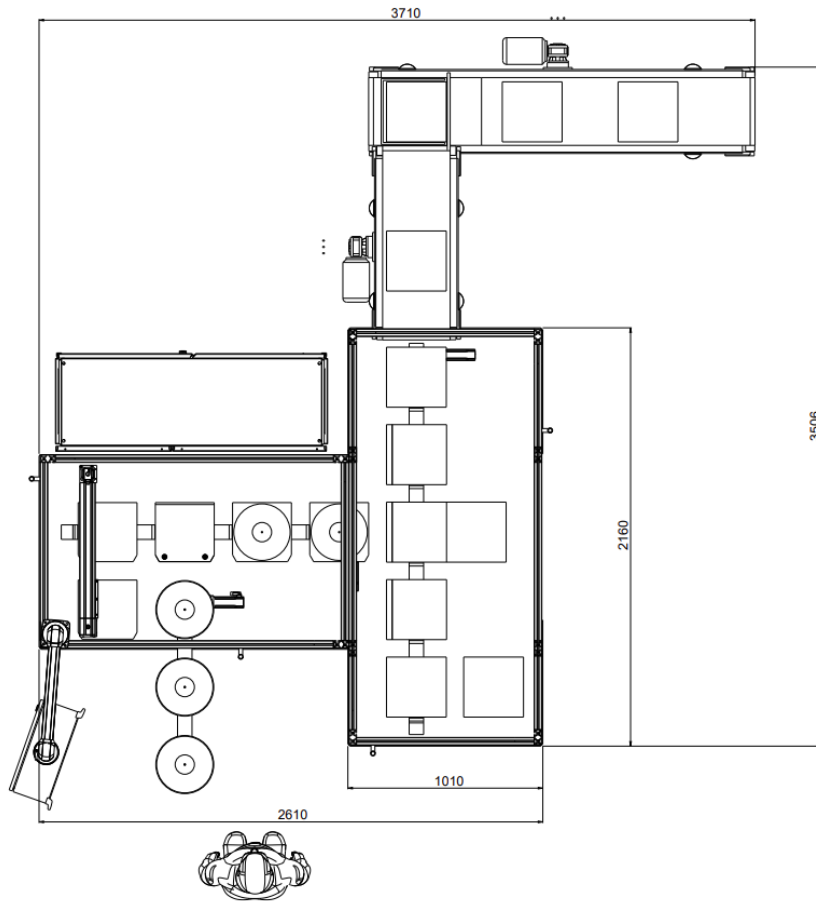

MODULE ZUMM

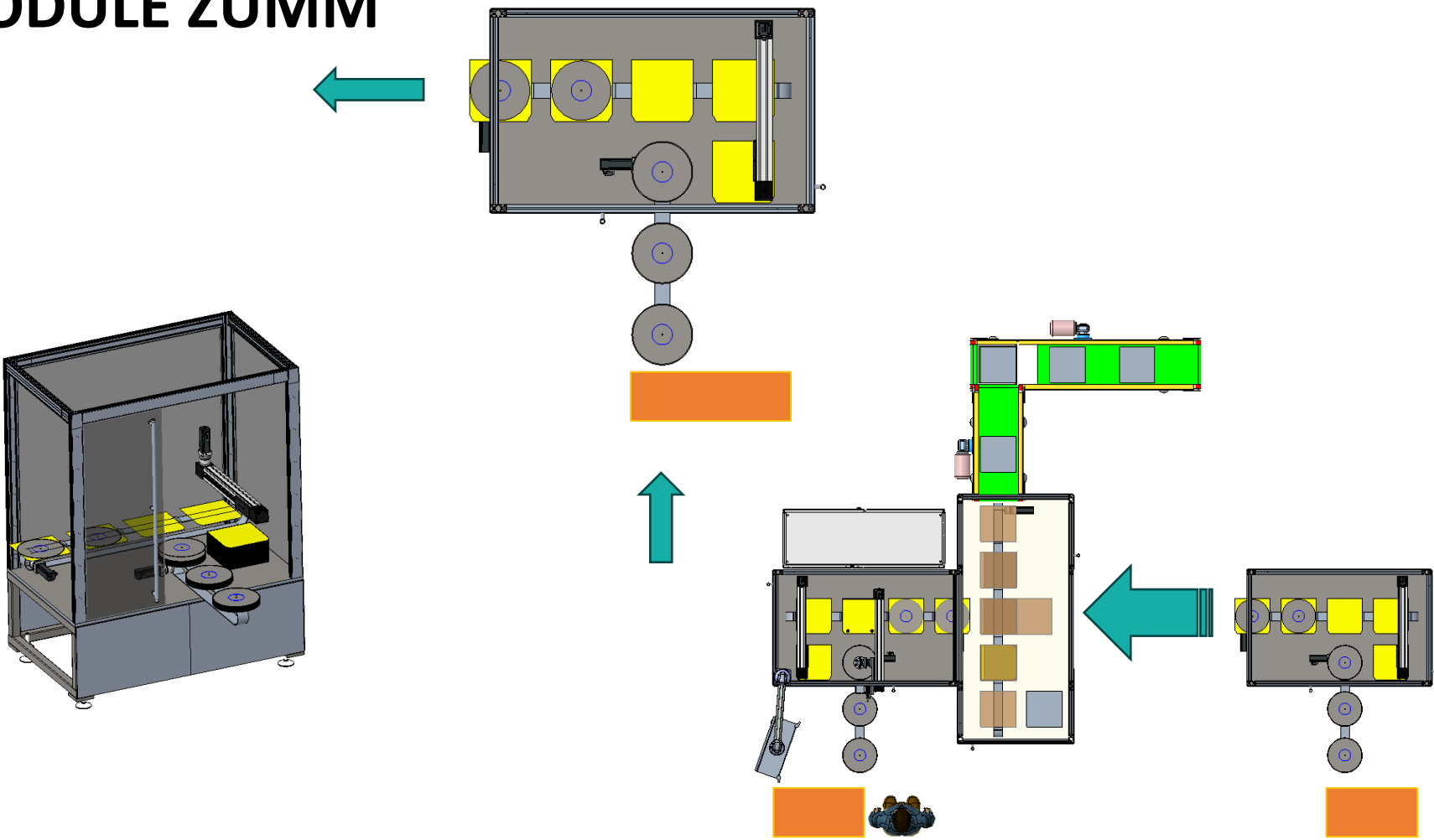

ZUMM 803

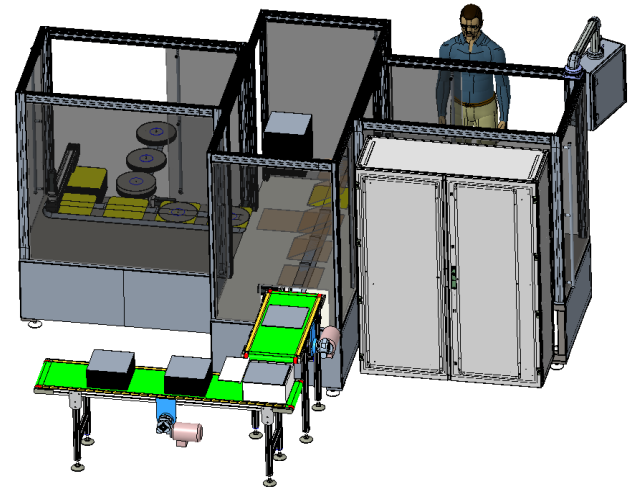
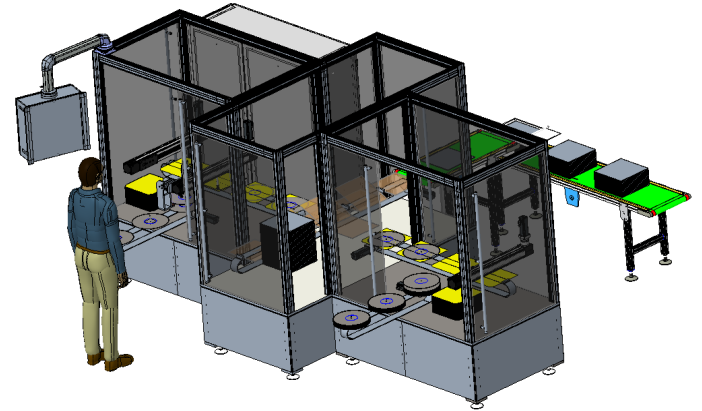
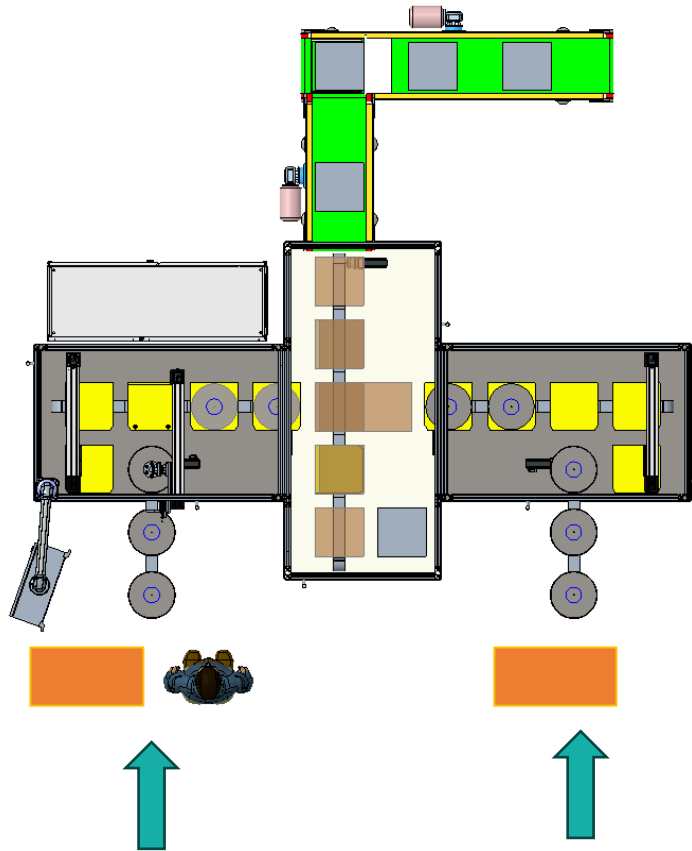

FUNCTIONS' DESCRIPTION S OF ZUMM 803

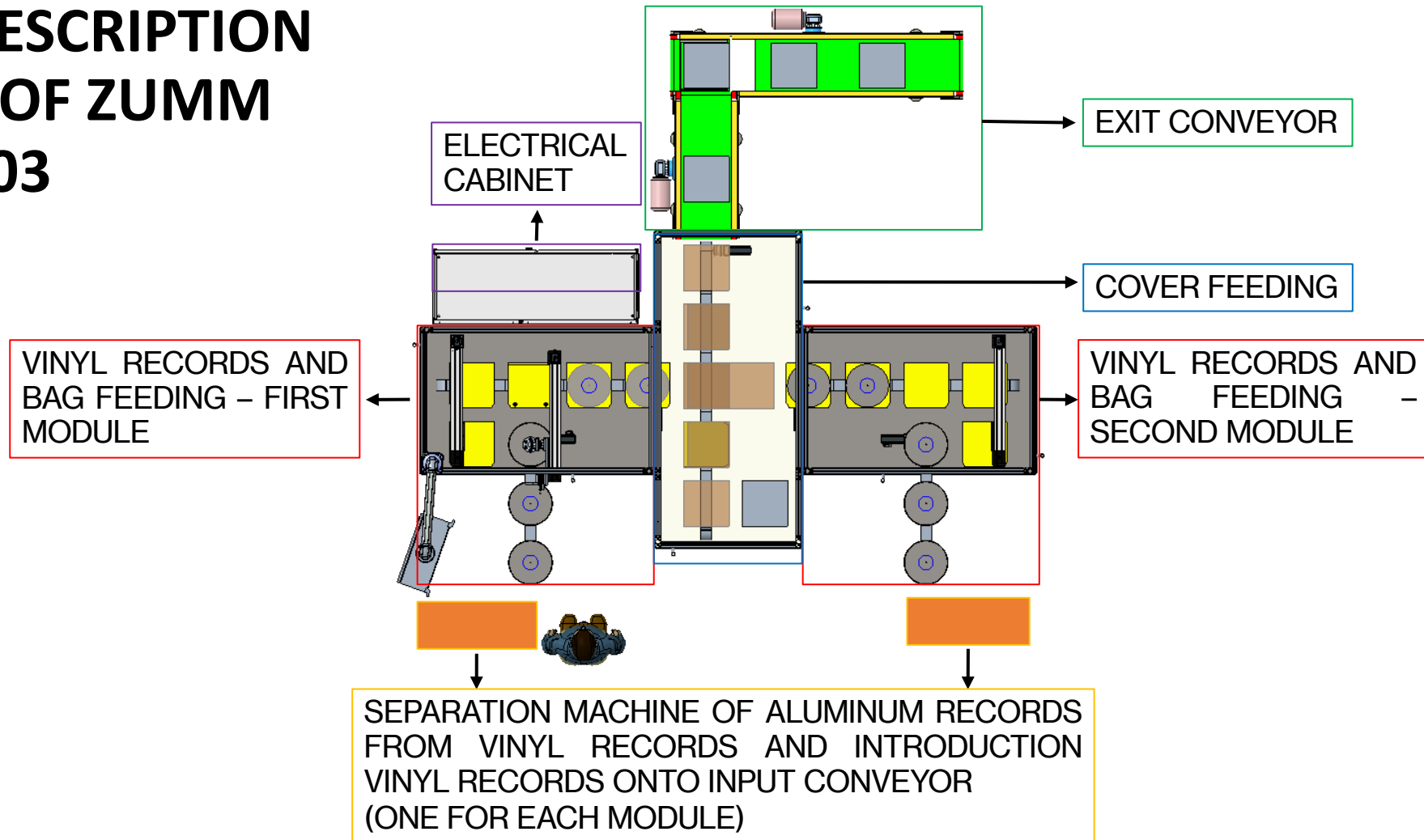

ZUMM 803

- LAYOUT

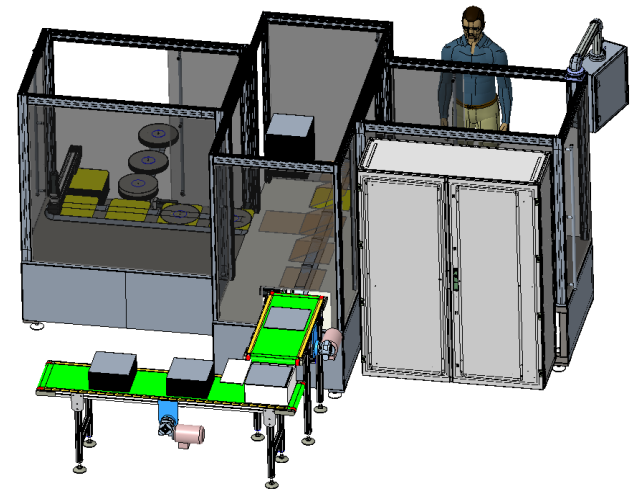
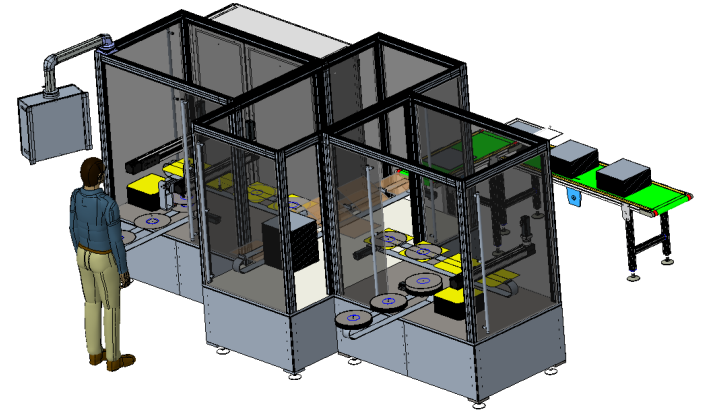
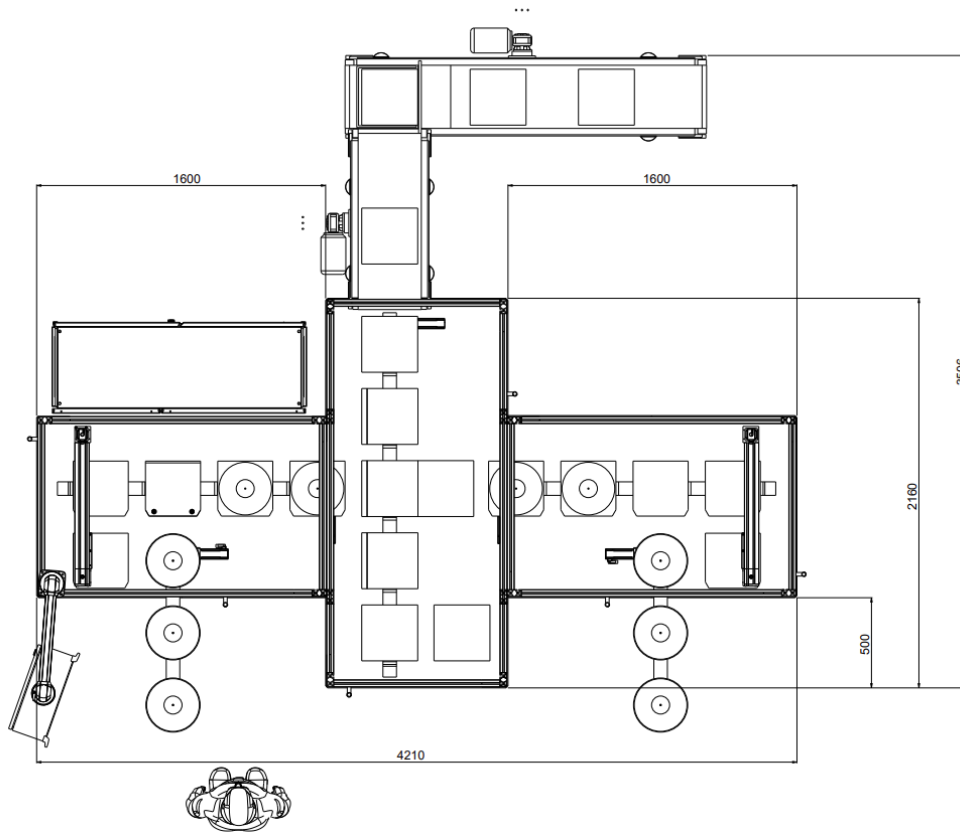

VYNIL RECORDS AND BAG FEEDING

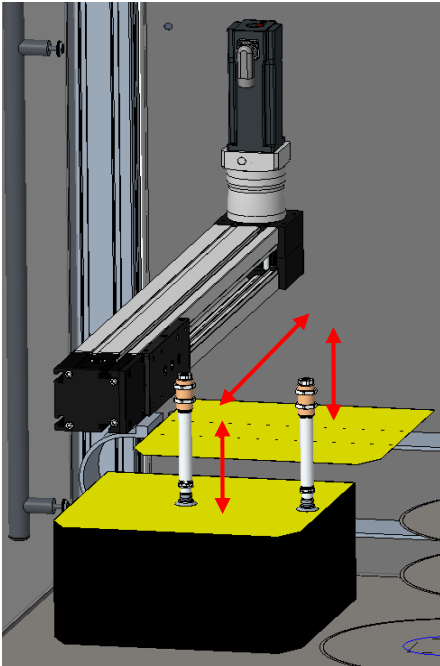

LINEAR AXIS TO PICK UP
FROM WAREHOUSE AND
PLACE THE BAGS ON THE
CONVEYOR

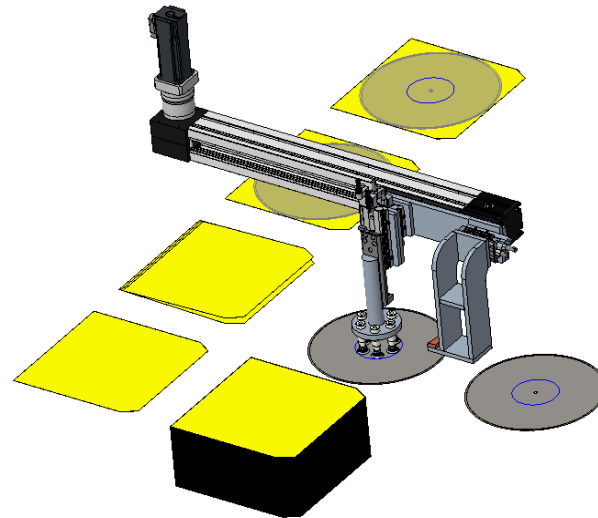

LINEAR AXIS AND PNEUMATICS
MOVEMENTS TO PICK UP FROM
WAREHOUSE AND PLACE THE VINYL
RECORDS INTO THE BAGS

INTRODUCTION OF VINYL RECORDS INTO THE BAG

PHASE 2: LIFTING VINYL TO BAG HEIGHT
WITH PNEUMATIC MOVEMENT

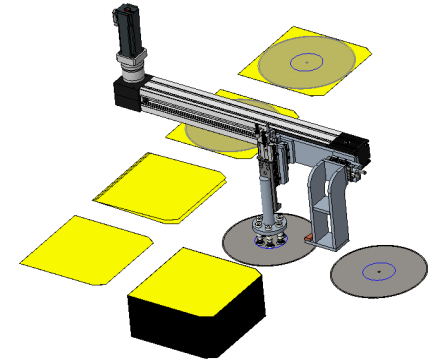
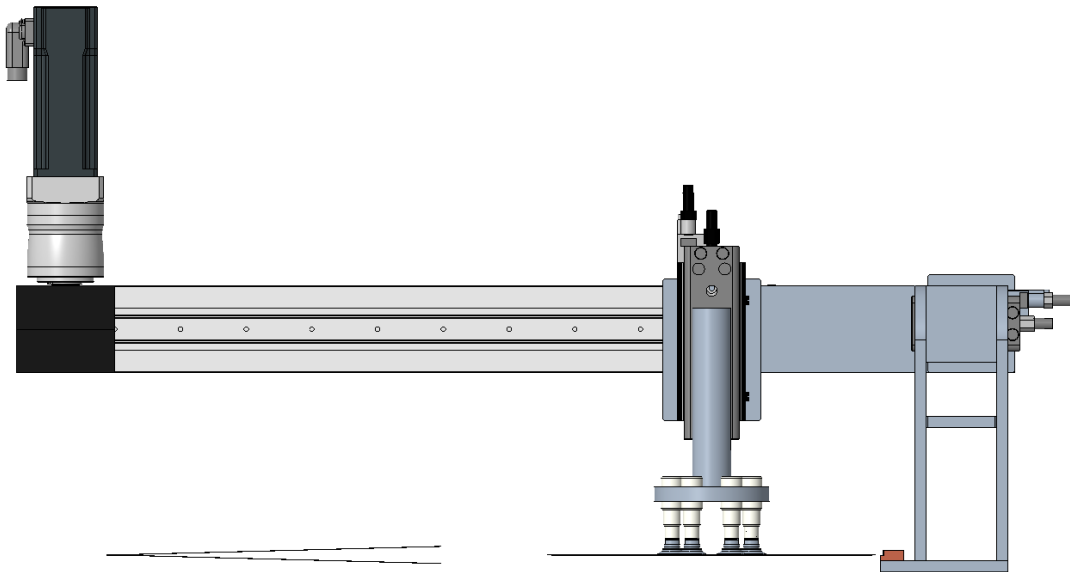

INTRODUCTION OF VINYL RECORDS INTO THE BAG

PHASE 3: PNEUMATIC APPROACHING
OF THE REAR TOOTH

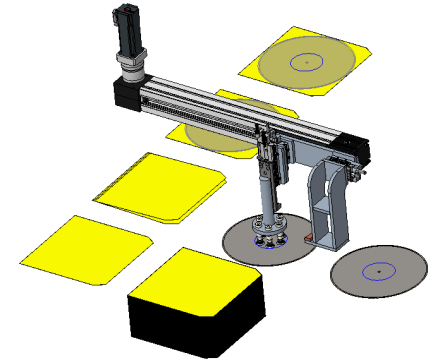
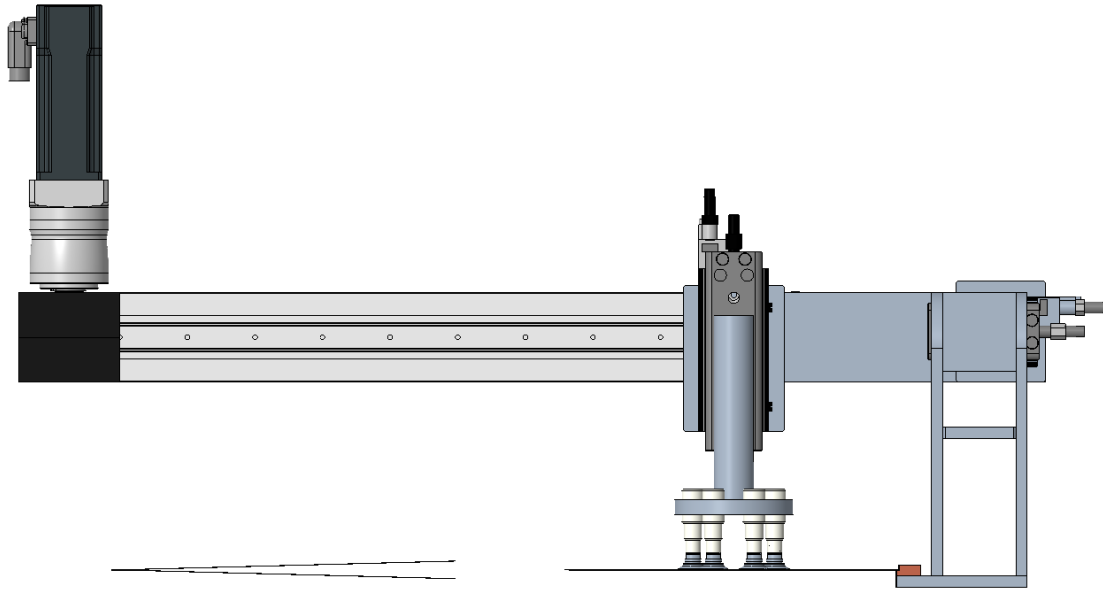

INTRODUCTION OF VINYL RECORDS INTO THE BAG

PHASE 4: INSERTION WITH LINEAR
AXIS OF THE VINYL INTO THE BAG

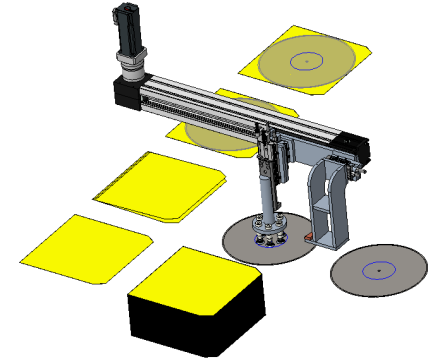
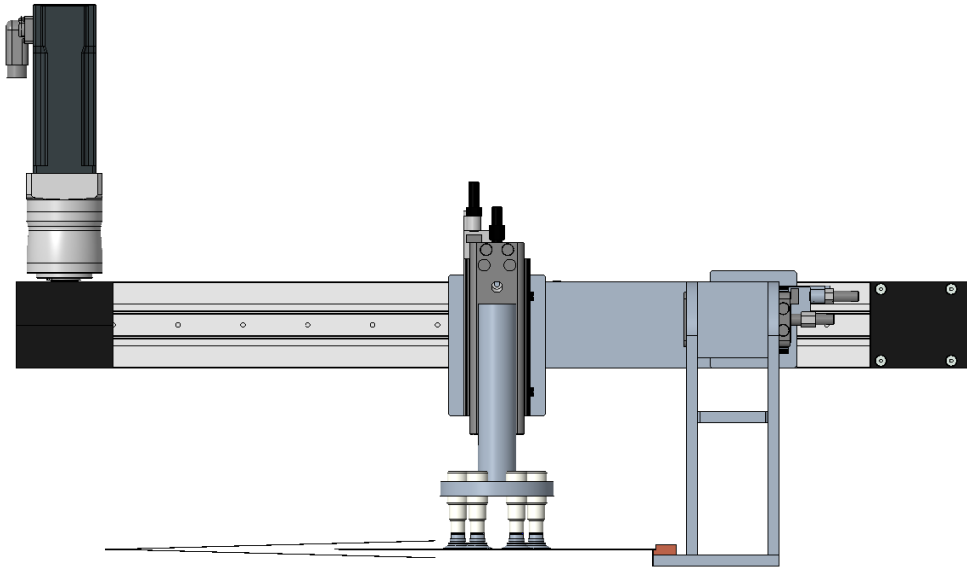

INTRODUCTION OF VINYL RECORDS INTO THE BAG

PHASE 6: DEFINITIVE INSERTION OF THE VINYL INTO THE BAG WITH LINEAR AXIS

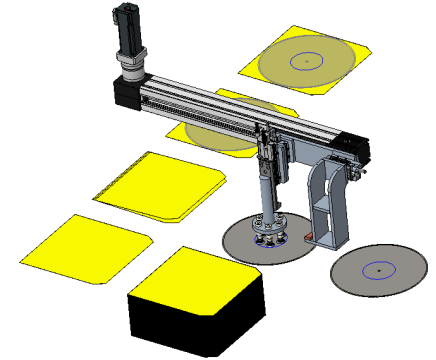
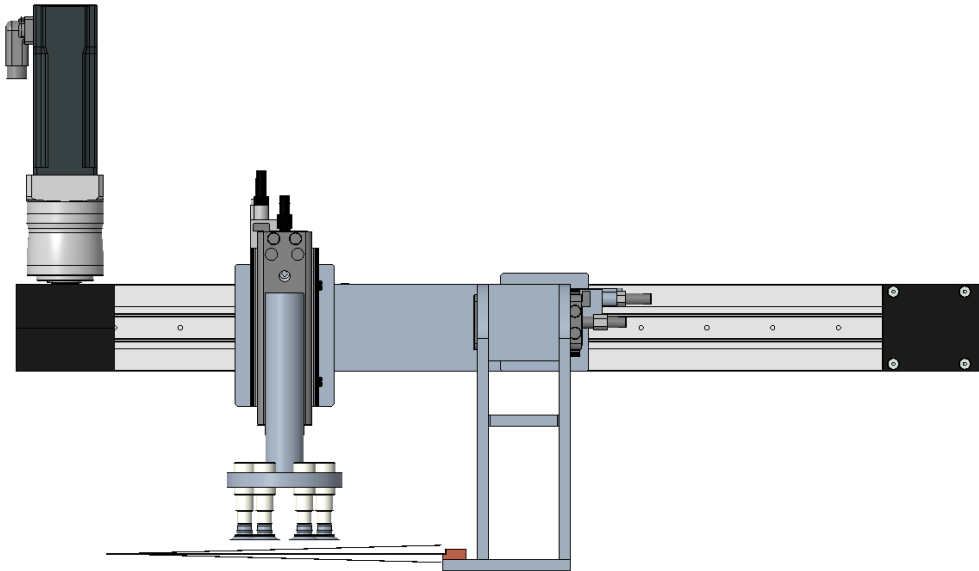

INTRODUCTION OF VINYL RECORDS INTO THE BAG

PHASE 7: MOVEMENTS RETURN IN PICK UP PHASE

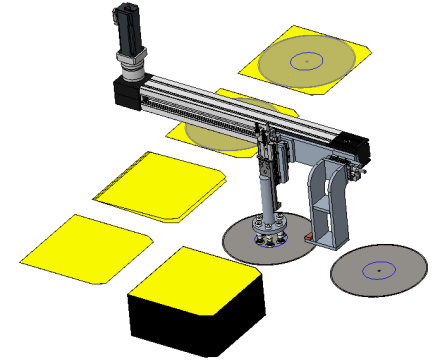
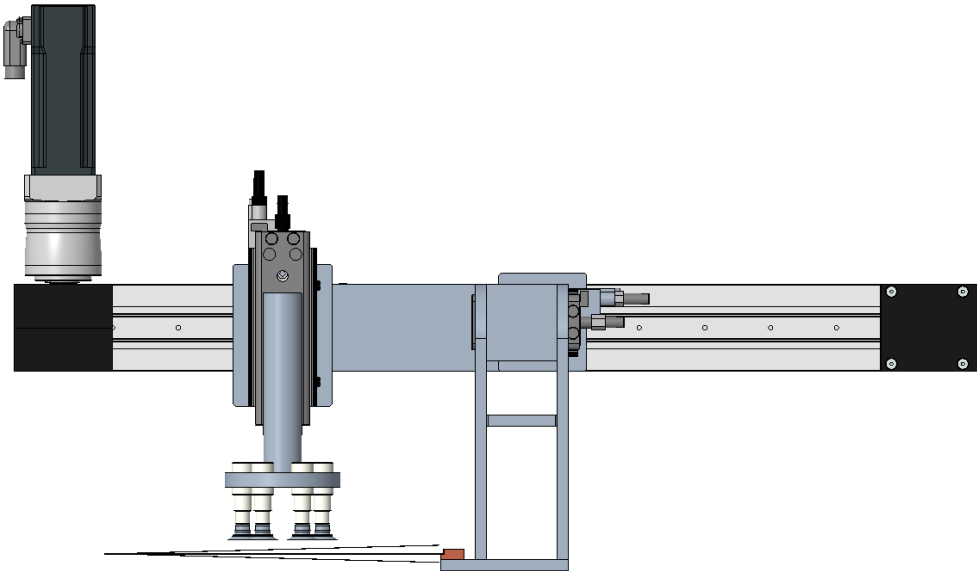

COVER FEEDING

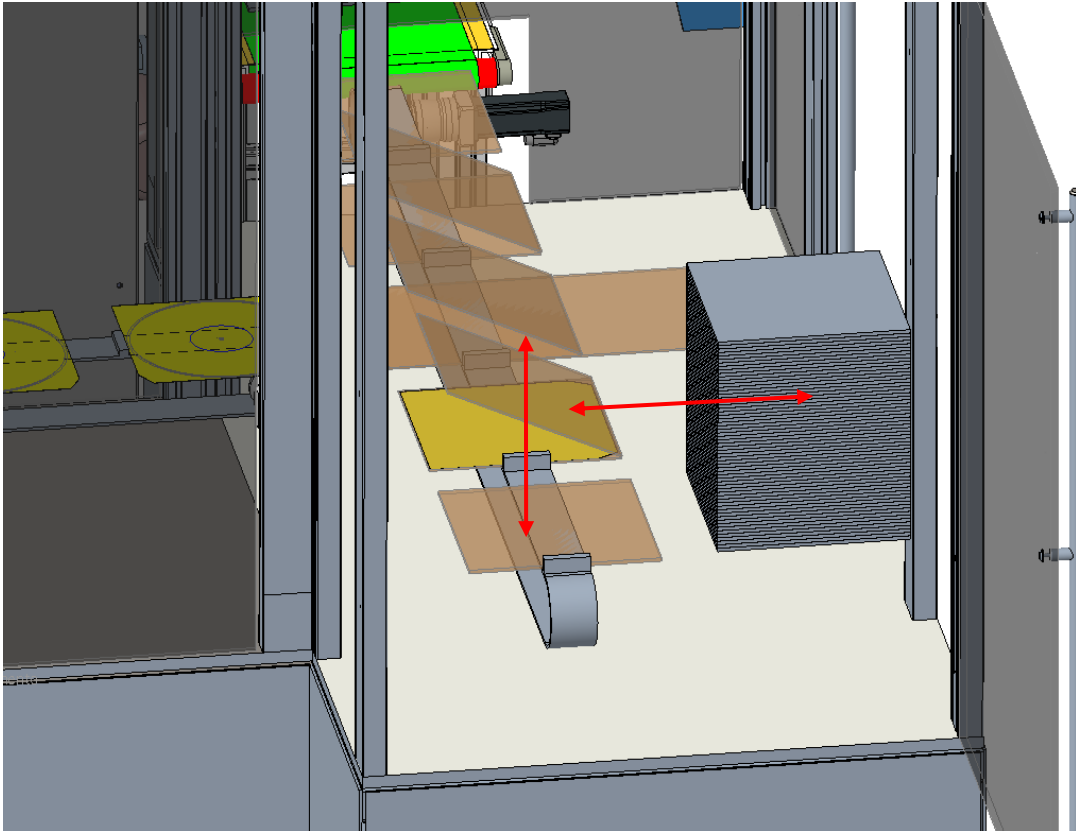

COVER WAREHOUSE AND
PICK UP AND PLCE COVER
ON THE CONVEYOR

COVER FEEDING

single module machine

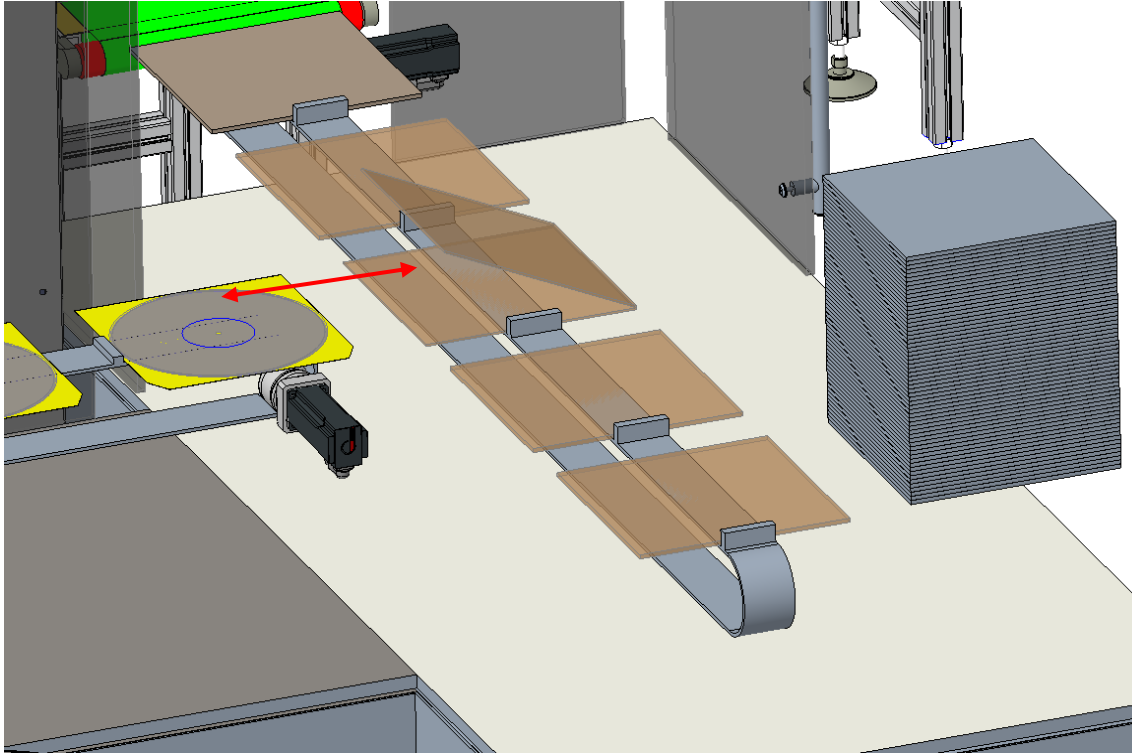

INSERTION VINYL
(ALREADY IN THE BAG)
INTO THE COVER

COVER FEEDING

double module machine

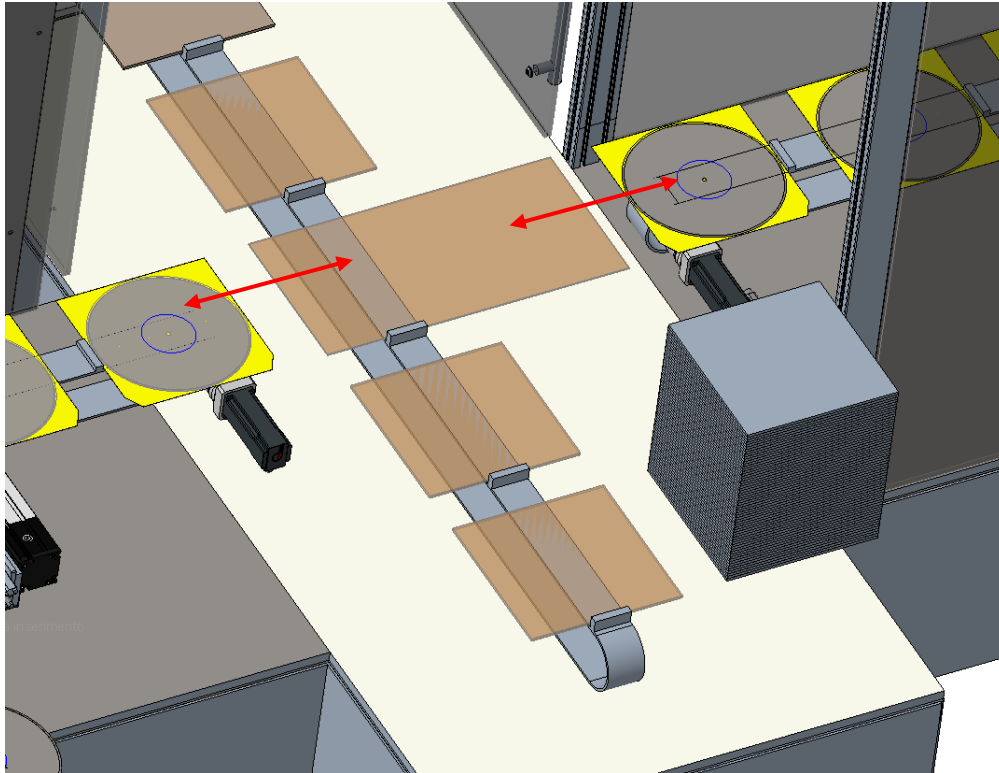

INSERTION VINYL
(ALREADY IN THE BAG)
INTO THE COVER

EXIT

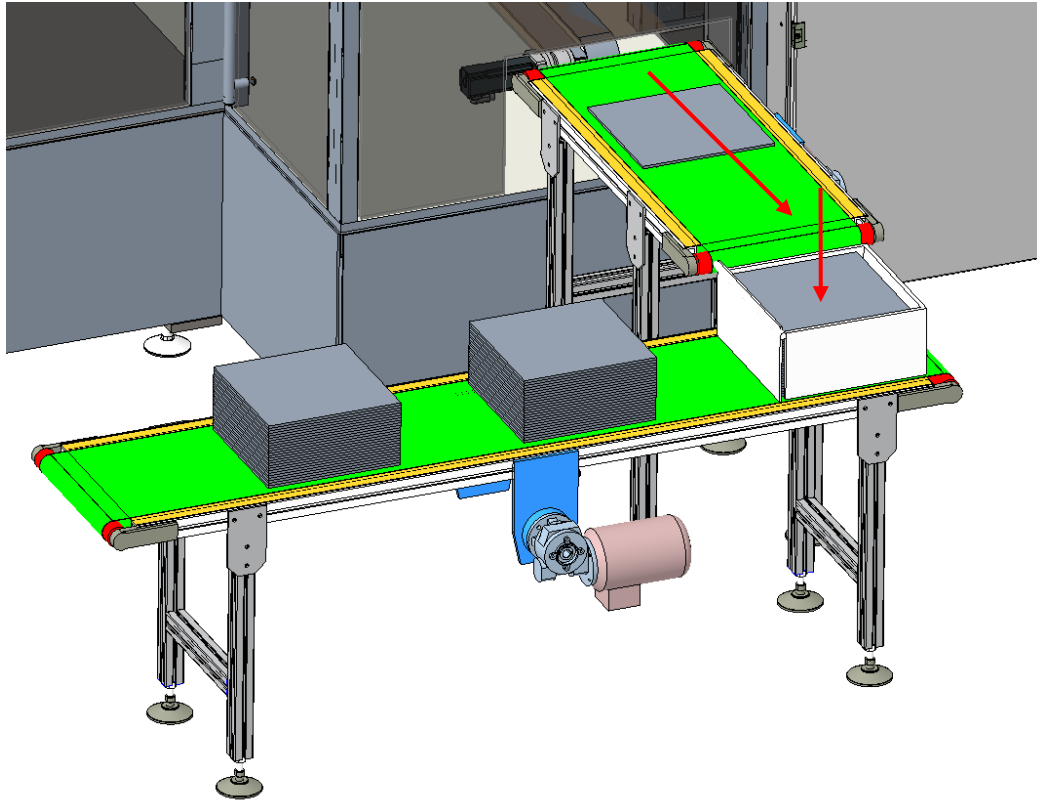

THE FINISHED PRODUCT IS
TRANSFERRED BY MEANS OF A
CONVEYOR INTO A PROPERLY
CLOSED STORAGE HOPPER

EXIT

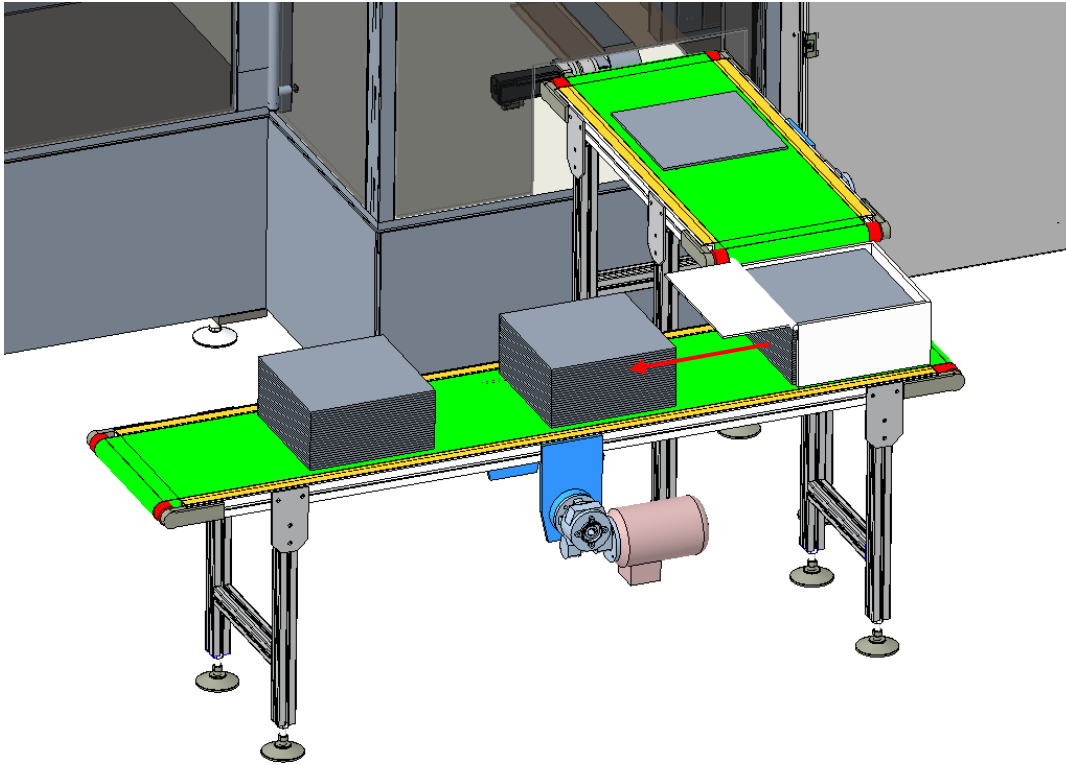

THE TRAP OPENS AND THE
PRODUCTS FLOW TOWARDS
THE OUTPUT CONVEYOR

COMPANY CONTACT

MSC srl

Franco Sironi

Tel: +39 02 96319009 / + 39 335.6296725

<http://www.mcssironi.com/>

Email: info@mcssironi.com

M-Tech Engineering Company

Man Lui

Tel: +44 7926531221 / +852 61680610

<https://www.m-tech-engineering.com>

Email: man.lui@m-techengineering.com